

# **PLASPLUGS®**

## **COMPACT DIAMOND WHEEL POWER TILE CUTTER**

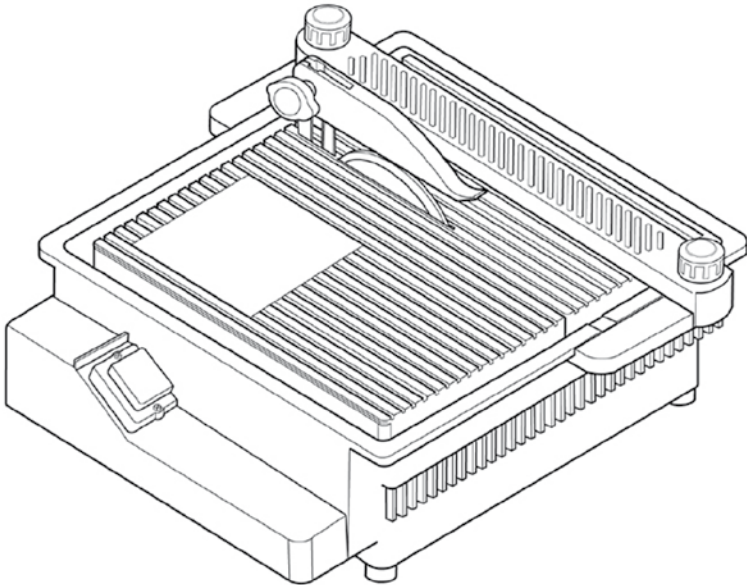

**MODEL NO: DWW082**

# **SAVE THESE INSTRUCTIONS**

## **KEEP IN A SAFE PLACE**

---

When using electrical tools, basic safety precautions should be always used including the following:

- Read and save all instructions.
- Unplug from outlet when not in use, before putting on or taking off any parts and before cleaning.
- To protect against electrical shock, do not immerse cord, plug or appliance in water or any other liquid.
- Do not operate any product with a damaged cord or plug, if the product malfunctions or it is dropped or damaged in any way.
- The use of attachments not recommended or sold by Plasplugs may cause fire, electrical shock or injury.
- Keep your work area clean – Cluttered benches invite accidents.
- Do not use in dangerous environments. Do not use in damp or wet conditions or expose machine in rain. Keep your working area well lit.
- Do not let the cord hang over the edge of table or counter or touch hot surfaces.
- Do not use product or attachments for other than intended purpose.
- Do not leave product unattended whilst it is operating.
- Do not overreach – keep proper footing and balance at all times.
- Keep all non-users a safe distance from the work area, especially children.
- Never touch the moving cutting wheel.
- Grinding generates sparks – keep away all flammable substances and materials.
- Maintain all tools with care. Keep tools sharp and clean for best and safest performance.
- To reduce the risk of unintentional starting, make sure that the switch is in the off position before plugging in.
- Never stand on tools.
- Always check for damaged parts before operation. Damaged parts should be properly repaired and replaced.
- Use extension cords intended for outdoor use. Ensure that the electrical rating and cord length is correct for the tool. Do not use damaged extension cords.
- Wear proper apparel – remove all loose clothing, neckties, rings, bracelets and other jewellery that may get caught in moving parts.
- Non-slip footwear is recommended.
- Wear protective hair covering to contain long hair.
- Ear protection and gloves are recommended.
- Always use safety glasses. NB Everyday eye-glasses do not contain impact resistant lenses – they are NOT safety glasses.
- Always use face or dust masks if cutting operation is dusty.
- Always connect to an electrical power point using an approved RCD circuit breaker. This is an essential safety precaution.
- For safety and to prolong the motor life, only switch the Tile Cutter on before cutting a tile. Switch off immediately after use.

**INTRODUCING YOUR PLASPLUGS COMPACT DIAMOND WHEEL POWER TILE CUTTER**

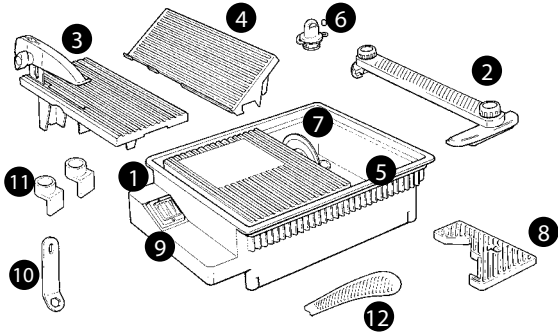

1. Motor Unit
2. Cutter Guide
3. \*Splash Guard, Riving Blade
4. Water Reservoir Cover/45° Mitre Guide
5. Water Reservoir
6. Drain Plug
7. \*High Glaze Diamond Cutting Blade
8. Angle Cutting Guide
9. Power Switch
10. 1 Spanner
11. 2 Bench Stops
12. Push Stick

\* Require fitting prior to use. Components located in the water reservoir.

**Fitting the Diamond Wheel Cutting Blade**

Remove the water reservoir cover. Follow diagram as alongside. Always fit the diamond wheel with the label/rotation arrow facing outwards. Tighten with spanner supplied.

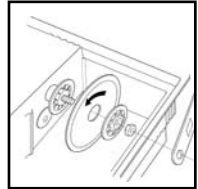

**Fitting the Splash Guard & Riving Blade**

Remove the water reservoir cover. Remove screw and slide Riving Blade up through the slot as shown (a). Lift and refit screw.

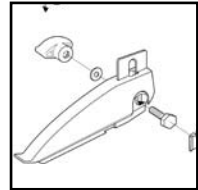
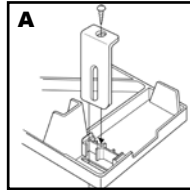

Follow diagram (b) to add the Splash Guard to the Riving Blade.

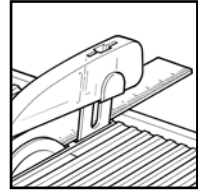

You should now align the Riving Blade. Place a straight edge against the cutting blade and adjust until perfectly aligned. Retighten the screw.

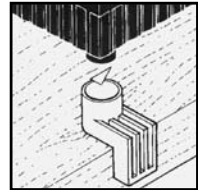

**CUTTING TILES WITH THE COMPACT DIAMOND WHEEL WALL TILE CUTTER**

- Fit the bench stops to the base. This will prevent the machine moving during operation.
- Remove the water reservoir cover. Ensure that the drain plug is fitted correctly as diagram.
- Fill with water to a depth of approx 20mm

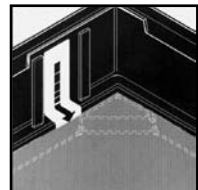
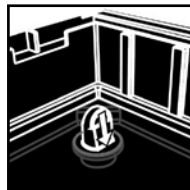

- Adjust splash guard up or down so that it is just above the tile surface.
- Slide the cutter guide on to the back and tighten as required. Guide can be adjusted and used on the left or the right of the wheel.
- A chinagraph pencil is recommended for marking the tile.
- **NEVER** touch the moving cutting wheel.
- Always use the push stick when making cuts close to the diamond wheel.

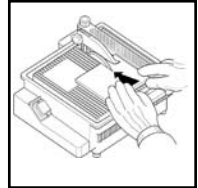
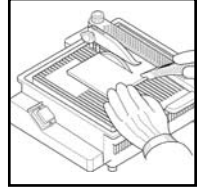

### **CUTTING STRAIGHT EDGES**

Line up the tile where the cut is required, with the diamond cutting blade. Use the cutter guide alongside the tile edge for support. Push the tile towards the wheel, using steady and even pressure. Do not use excess pressure – if this is needed, check for alignment of the Riving Blade, Cutting Guide or check if the diamond wheel is worn.

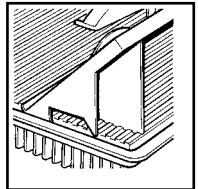

### **CUTTING 45° MITRES**

Fix the mitre guide into position, following the diagram provided.

Place the tile, glazed front facing down onto the guide and feed through the wheel.

Always leave a small flat on the tile edge to avoid sharp edges and chips.

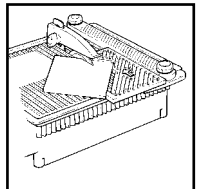
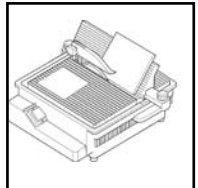

### **MAKING DIAGONAL CUTS**

Use the angle cutting guide as shown - always keeping both the tile and the guide firmly pressed against the main cutting guide as you cut.

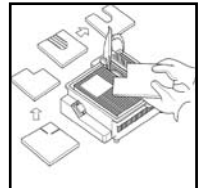

### **CUTTING CURVES, SQUARES & CIRCLES**

Gloves are recommended for this application. Draw the shape required onto the tile.

Lift up the splash guard and use the top of the wheel to cut your shape.

Recommended for advanced users only.

## **CARE & CLEANING**

- Before cleaning disconnect from the mains.
- Always clean sludge thoroughly from reservoir after use. Wash with a clean damp cloth. Do not use a water jet or hose.
- Keep the tile cutter free from oil and grease. Store in dry conditions.
- No regular servicing is required. In the unlikely event of operating difficulty please contact Plasplugs direct.

## **REPLACEMENT DIAMOND WHEEL BLADES**

Always use Plasplugs genuine replacement blades. Product code reference HGDW082.

To replace the cutting blade, remove nut and large washer from shaft, place new blade on shaft with rotation arrow/ label facing outwards. Refit washer and nut and tighten with spanner.

## **ONE YEAR GUARANTEE**

Your Plasplugs product is guaranteed for one year from date of purchase, against electrical and mechanical defects in material and workmanship. Repairs or part replacement required as a result of such defects will be made free of charge during this period. Proof of purchase must be provided.

This guarantee does not cover damage caused by misuse, negligence or use on current or voltage other than that stamped on the product. The guarantee is invalid if the machine has been dismantled or interfered with in any way and persons other than Plasplugs' consumer care department have attempted repairs.

This guarantee is in lieu of any other warranty expressed or implied. This warranty does not affect your statutory rights.

For after sales care or any other additional questions you may have regarding Plasplugs extensive tiling tools range, please contact our free-phone number on 0800 243159.

## **TECHNICAL SPECIFICATION**

Power Supply: ~230V 50Hz

Power: 300W

RPM Geared Output: 4600min<sup>-1</sup> (no load)

Max Sound Level: 90dB(A)

To Cut: ceramic, quarry and terracotta tiles

Max Depth of Cut: 12mm

**CERTIFICATE OF CONFORMITY -**

**DWV082 COMPACT DIAMOND WHEEL POWER TILE CUTTER**

I, the undersigned N. A. Turner of Plasplugs Limited, Wetmore Road, Burton-on-Trent, Staffordshire, DE14 1SD, certify that the above product has been tested and found to comply with:

IEC 1029-1:1990

IEC 1029-2-7:1993

72/23 EEC low voltage directive

89/336/EEC EMC directive

VDE 0741:1963-08

EN 50144-2-5: 1997-03 (sec 7.1 & 18. 10.1)

Signed



N. A. Turner, Director

1st November 2000



Plasplugs Ltd

Wetmore Road Burton on Trent Staffordshire DE14 1SD UK

Tel: +44(0) 1283 530303 Fax: +44(0) 1283 531246

<http://www.Plasplugs.com>

© 1998 Plasplugs Ltd

Due to minor changes in design or otherwise, the product you buy may differ slightly from

the one shown in this manual. Approved by EEC Standards

Part No: 062513238